



U.S.

CABINET
DEPOT

FRAMELESS

PRODUCT LINE
SPECBOOK

TABLE OF CONTENTS

Section 1: Policies & Information	About Us.....	2
	Ordering Information.....	3
	Dealer Sales Tools.....	4
	Terms & Conditions.....	6
	Frequently Asked Questions.....	9
	Construction Notes.....	10
	Warranty.....	11
Section 2: Alpine Styles & Pricing	Palermo.....	12
	Torino.....	13
	Riviera.....	14
	Construction Specifications.....	15
Section 3: Alpine SKUs & Specifications	Wall Cabinets.....	16
	Base Cabinets.....	21
	Tall Cabinets.....	27
	Vanities.....	33
	Panels, Fillers & Mouldings.....	36
	Accessories.....	39

About Us

US Cabinet Depot is a blend of cabinetry professionals from many different areas of the cabinet industry. This mix of knowledge and experience has allowed us to build a company that truly understands the needs of its customers. Our focus is on providing products that exceed our customers' expectations in quality, price and service.

QUALITY

Our products are designed to the highest standards in style and function. We start by selecting only high quality raw materials, hardware, adhesives, and finishes. This bundle of superior components is the first step to securing your long-term satisfaction.

The second step is a state of the art manufacturing process which ensures consistent production across the board. We have worked diligently to cut out waste and eliminate bottle necks. New manufacturing technologies are quickly implemented as they become available to the industry. The result is streamlined and efficient production costs which support a very competitive sales price for our products.

The last step is thorough inspections. Components are inspected for quality at the completion of each step of the manufacturing process. When the entire process is complete, each batch of products is compared with a control group to make sure it will match warehouse inventory perfectly. These quality standards were established so our customers have confidence in the consistent quality of our construction, color and finish.

SERVICE

We believe a product is only as good as the service that supports it. We spend a lot of time developing materials, processes and policies in order to make sure our customers are better served. The services we provide can be divided into three categories: supporting materials, order processing and customer service. Large strides have been made to ensure all of the pertinent information customers seek is readily available. Marketing materials are constantly being developed and distributed to help our customers educate their clientele. We understand that these are the sales tools required to successfully sell our products in your showrooms.

Our automated order processing system has allowed us to eliminate many unnecessary steps, significantly reducing our lead time. Orders placed online seamlessly flow through our inventory control and accounting systems.

We have a great team of experienced cabinet professionals ready to hear your concerns and answer your questions. Most importantly we listen to the input our customers give us and make sure your suggestions are addressed as we continually seek ways to better serve you. The goal is to establish a mutually beneficial relationship in which we can grow our businesses around.

STEP 01

REGISTER TO BECOME A DEALER

Visit our website at www.uscabinetdepot.com

Click on the "Become A Dealer" Link and fill out the form with your business information. Once your application is received it will be reviewed and processed within 48 hours. During the review process your sales rep. will be assigned, your pricing will be established and your account will be activated.

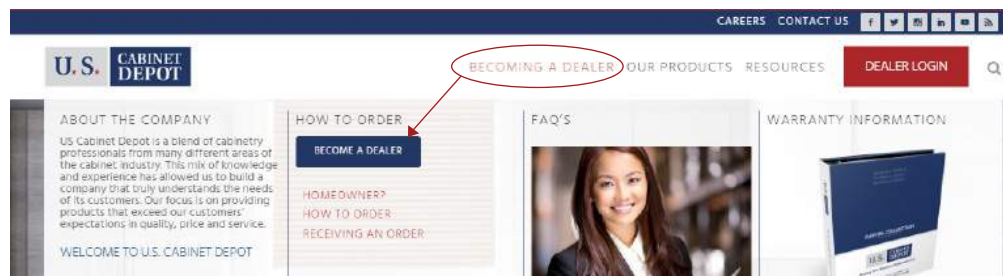

STEP 02

CABINET STYLE SELECTION

From the homepage, click on 'Shop Now' from the toolbar. Next, click on the collection you would like to shop. From there you can select your cabinet style preference.

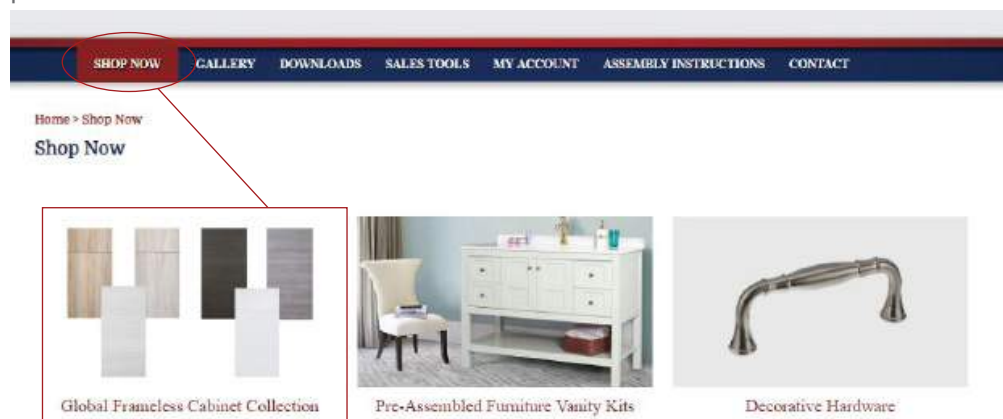

STEP 03

SELECT PRODUCTS TO ORDER

Add the desired products to your shopping cart. Start by sorting the items using the category buttons listed on the left-hand side of the page. Select your quantity and click the shopping cart to add to your order. Once you have added all your items, click the shopping cart button at the top right corner or bottom floating cart to proceed to checkout.

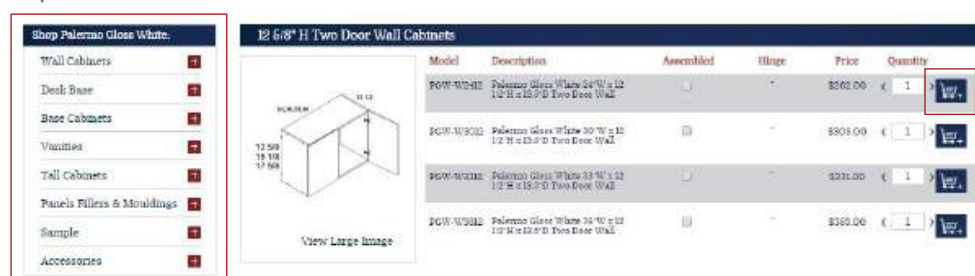

Sample Doors

ALPINE SERIES

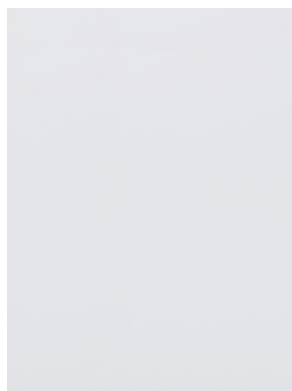

TITLE	DESCRIPTION	PRICE
PALERMO GLOSS WHITE	SAMPLEDOOR 11"W X 15"H	\$11



TITLE	DESCRIPTION	PRICE
TORINO WHITE PINE	SAMPLEDOOR 11"W X 15"H	\$11



TITLE	DESCRIPTION	PRICE
TORINO GREY WOOD	SAMPLEDOOR 11"W X 15"H	\$11



TITLE	DESCRIPTION	PRICE
TORINO DARK WOOD	SAMPLEDOOR 11"W X 15"H	\$11



TITLE	DESCRIPTION	PRICE
RIVIERA OYSTER SHELL	SAMPLEDOOR 11"W X 15"H	\$11



TITLE	DESCRIPTION	PRICE
RIVIERA CONCH SHELL	SAMPLEDOOR 11"W X 15"H	\$11

Marketing Tools



TITLE	DESCRIPTION	PRICE
ALPINE SALES SHEET	PACK OF 50 SHEETS	\$7



TITLE	DESCRIPTION	PRICE
STYLE GUIDE	PACK OF 10 STYLE GUIDES	\$10



TITLE	DESCRIPTION	PRICE
SPECBOOK	FRAMELESS SPECBOOK	\$15



TITLE	DESCRIPTION	PRICE
FRAMELESS MARKETINGKIT	1 PACK ALPINE SHEETS, 1 PACK STYLE GUIDES, 1 SPECBOOK	\$20

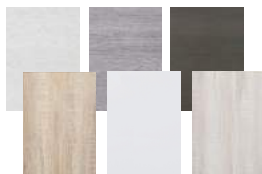

TITLE	DESCRIPTION	PRICE
SAMPLE DOOR KIT	5 UNLABELED DOORS	\$50



TITLE	DESCRIPTION	PRICE
DISPLAY SPINNER	INCLUDES ALL SAMPLE DOORS, TRIM DISPLAY BOARDS, EXTRA DISPLAY BOARDS, 2 CLEAR BROCHURE HOLDERS, FULL BASE 24 AND SPINNER HARDWARE	\$800

*\$400 REBATE AFTER INSTALLATION

DISPLAY POLICY:

US Cabinet Depot is happy to partner with our displaying dealers. We now offer a 50% credit on US Cabinet Depot products that are ordered and installed in a dealer's showroom. Products can only be for display, not for functional use (desks, bathrooms, breakrooms, etc. are not eligible for rebate). Each dealer can earn up to a total of \$2,500 in credit per calendar year. The display items must be ordered online, paid in full and pictures of full showroom installation sent to info@uscabinetdepot.com before a credit can be released.

Terms & Conditions

ORDER PROCESSING & PAYMENT

- All order from US Cabinet Depot approved dealers will be accepted online only.
- Full payment is required before an order will be processed.(This includes backorders and approved written add-ons).
- Payment can be made by Credit Card, Debit Card or Paypal.
- Once the order is in process, no changes can be made. Additional items can be processed online as a new order.
- Frameless flat pack orders are processed in 3 full business days. Frameless assembled orders are processed in 5 full business days.
 - "Day one" starts on the NEXT full business day after the order is placed.
- Cancellations after the order is picked will be subject to a 10% processing fee.
- Cancellations after an order has shipped are subject to a 20% restocking/processing fee.
- RUSH ORDERS are not accepted for frameless orders.

ASSEMBLY & MODIFICATIONS

- Assembly is available for warehouse pick up and freight shipped orders for additional labor and shipping fees as calculated by the website.
- At this time, the only modification we offer for our Global Frameless Collection is decreased depth. Please contact us for more details.

SHIPPING & DELIVERY

- All unassembled flat pack frameless orders will be ready to ship or pick up within 3 full business days.
- All assembled frameless orders will be ready for pickup within 7 full business days.
- All freight orders are packaged individual boxes, placed on a pallet, shrink wrapped and strapped.
- All freight LTL shipping charges are calculated online.
- US Cabinet Depot manages all shipping. Third party freight carriers cannot be sent by the dealer to pick up orders.

SHIPPING

- 2-5 business day standard transit time with LTL carriers. Please account for at least one extra day for residential and scheduled delivery appointments.
- Shipping charges must be paid for when your order is placed online. (Orders exceeding standard LTL sizes are subject to additional fees for Full Truckload shipping.)
- Orders cannot be held. However, you can select to ship at a later date during the checkout process Please see example image.
- You will receive a tracking number by email the day after the order has shipped.
- All destinations must be tractor/trailer accessible or Limited Access fees will be applied (\$100).
- For 'Residential Deliveries' and appointment deliveries, the freight company will contact you 24 hours in advance to schedule the delivery (usually a 3-4 hour window).
- Shipping charges cover ONE delivery attempt. The customer will be responsible for any additional shipping and handling charges for delivery failure due to customer circumstances.

Ship my order at a later date

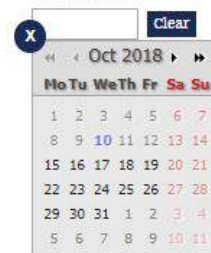

DELIVERY POLICIES

- The driver is responsible for placing the pallet on the ground for deliveries that had liftgate services selected at the time of checkout.
- Address classifications are based on city zoning. Therefore, it is possible to have a commercial property in a residential area. In this case, the delivery would be considered residential and is subject to the 'Residential Delivery' fees and conditions.
- A responsible party must be present to inspect inventory of the shipment and sign off on the delivery.
 - It MUST be notated if the number of pallets being delivered does not match the number of pallets listed on the driver's BOL copy.
 - Careful inspection of packaging condition is vital to freight claims. Even if you are unsure if the contents inside contain damages due to the exterior condition, you MUST indicate damages on the BOL to be able to claim concealed damages in the future.
 - Do NOT reject damaged items. SEE IMPORTANT NOTES IN MISSING AND DAMAGED ITEMS SECTION TO FOLLOW.

PICK UP ORDERS

- Orders MUST be picked up within 5 business days of ready for pickup notification.
- Orders not picked up within 5 business days are subject to a storage fee of \$25 per pallet, per day.
- Orders not picked up within the allotted 10 business days will be returned to stock, incurring the storage fee and a 10% restocking fee that will be deducted from the total refund of the order.

MISSING OR DAMAGED ITEMS (INCLUDING CONCEALED DAMAGE)

- Freight claims for obvious damage or shortage can only be accepted when indicated on the BOL.
- Freight damage claims must be filed within 5 business days. No claims will be allowed without the proper paperwork.
- To file a claim for a damage or a shortage, please log into our website and use our claim module.
- All damages must be documented and reported upon opening the boxes.
- The following must be included to process the claim:
 - Order number
 - Buyer's name
 - Shipping address for replacements
 - Brief description of damage or shortage, including item numbers and/or parts
 - PICTURES of the damage and required
- Upon receipt of the damage claim, we will review the request within 48 business hours. Replacements will then be shipped out within 24-48 hours.
- Expedited shipping services are NOT available for replacements and/or parts.
- All damages must be documented and reported upon opening the boxes. Items that have been assembled or installed cannot be claimed as damaged.
- US Cabinet Depot cannot be held responsible for any labor costs accrued during the installation of any of its products sold via any of its channels of distribution. This includes, but is not limited to, items that may be flawed or have become damaged in transit.

Terms & Conditions-Continued

RETURNS & REPLACEMENTS

- All returns must be authorized by US Cabinet Depot prior to return shipment.
 - For authorization, please send an email request to: support@uscabinetdepot.com
- Returns must be received by US Cabinet Depot within 30 days of purchase.
- All items must be returned in original, unopened packaging. Therefore, NO RETURNS ON ASSEMBLED CABINETS.
- No returns on trims, mouldings, fillers, panels or sales tools.
- QUALIFYING returns will incur a 20% restocking/processing fee.
- The customer is responsible for setting up and covering all return shipments.
- Any returned product deemed unsellable WILL NOT RECEIVE CREDIT.

MARKETING POLICIES

- US Cabinet Depot cannot be held liable for applicable costs for marketing our products.
- Private labeling is done at the dealer's discretion.
- The use of any images and sales materials in your private label marketing can be released by emailing info@uscabinetdepot.com.

Frequently Asked Questions

CONSTRUCTION

- Are your products CARB2 certified?
Yes, all US Cabinet Depot products are 100% in compliance with CARB Phase 1 & CARB Phase 2 defined guidelines of composite wood products.
- Are your cabinets strong enough to support a granite top?
The construction of our cabinetry ensures the strength required to support granite, concrete and/or any other countertop material that you may select. No additional cabinet reinforcement is required.
- What type of materials are used in the construction of your frameless cabinets?
The Alpine Series frameless cabinet box is constructed using composite plywood and MDF panels. The engineered wood doors have a textured melamine or laminate finish.
- How is the interior of the cabinet finished?
Our Alpine Series cabinets feature a white and grey linen thermofused melamine interior.
- Is a finished panel required for exposed ends?
The Alpine Series features a standard white and grey linen thermofused melamine exterior, so panels are required to finish the exposed ends on a run.
- How much weight can your drawers hold?
Our Alpine Series 30" drawer boxes and below have a weight capacity of 88 lbs. The 30"+ drawer boxes have a weight capacity of 166 lbs.

ORDERING

- What forms of payment do you accept?
We accept all major credit cards (Visa, American Express, Mastercard & Discover) and PayPal.
- How can I check on the status of my order?
You can view the status of your orders by logging onto your account and selecting the 'My Account' page. From the left-hand menu options, select 'Frameless Orders'. The order status will be displayed, as well as tracking information for all fulfilled orders.
- Do you offer credit terms?
We currently do not offer credit terms to our customers. All orders must be paid in full prior to shipping.
- What is your return policy?
We do accept returns in certain circumstances. Please review the 'Returns and Replacements' section of our Terms and Conditions for details.

DELIVERY

- How do you ship your cabinetry?
Most orders will be shipped on a pallet via LTL (Less Than Truckload) common carrier. Orders less than 50 lbs may ship via UPS.
- How long will it take to receive my cabinets?
All flat pack orders are processed and shipped out of our facility within 3 full business days. Assembled orders are processed and shipped out of our facility within 6 full business days. Transit time to your location can vary from 1-6 business days depending on your location. Backorders are exempt from normal lead times.
- What if my delivery includes damaged cabinets?
Please notate any damages with the freight company on the BOL when accepting the delivery and take photos of the damaged items. Submit a claim online with the photos of the damages or send them immediately to support@uscabinetdepot.com. US Cabinet depot will review and replace damaged pieces in a timely manner.

Construction Notes

GLOBAL FRAMELESS COLLECTION

ALPINE SERIES

- Clean and contemporary frameless styling
- 18mm Plywood construction (CARB2 Compliant)
- Thermofused melamine surface inside and out
- Universal white and grey linen pattern cabinet box
- All edges are banded with a thick, matching PVC edge banding with radius edges
- Wood dowel and 2 ½" confirmat screw assembly
- Broad line of available cabinet SKUs
- All door styles include integrated 'stay put' door bumpers
- Cabinet components are packaged and available separately to add overall versatility
- Featuring full extension Blum 'Legrabox' premium metal drawer boxes
 - 550mm deep kitchens
 - 450mm deep vanities
- Hettich 'Sensy' integrated soft-close hinges
- Drawers 30" and over use 166 lb. heavy duty runners
- Bases, tall and vanity cabinets use adjustable leveling feet
- All 23" high wall cabinets have one shelf
 - 30" & 35" have two shelves
 - 40" has 3 shelves

Warranty

LIMITED LIFETIME WARRANTY

Brothers Global Inc. warrants to the original consumer purchaser that US Cabinet Depot cabinetry, door hinges, and drawer glides will be free from defects in material and workmanship under normal use and service for the lifetime of the product (Proof of Purchase is required). This warranty is not transferable and only applicable to product used for residential purposes. Representatives of US Cabinet Depot do not have the authority to change or enlarge this warranty.

This warranty does not cover normal wear and tear, damage or defects caused by accidents, misuse, abuse, or lack of necessary maintenance; nor does it cover alteration, modification, improper installation, improper handling/storage, environmental conditions, nor any labor costs.

Brothers Global Inc., at our option, may elect to repair or replace with functionality equivalent product any US Cabinet Depot product covered by this warranty. Some replacement parts are subject to availability and may differ from original parts received. Return of defective product may be required for a replacement to be issued. Repair parts or replacement parts are at the expense of Brothers Global Inc., but customer shall bear all other expenses. These expenses may include, but are not limited to, cost of removal and reinstallation of product, labor, expenses, etc.

Just as no two trees are alike, no two pieces of wood are alike. The variation in color and grain pattern on wood adds to its natural beauty and is not considered an imperfection. Environmental factors, including but not limited to, artificial / natural light, moisture, cleaners, smoke, etc, may cause the darkening or mellowing of a cabinet over time. This is a natural process and can be expected. This warranty does not cover the natural aging or darkening / mellowing of wood color, the inherent growth characteristics of, or variation in wood.

Some of the cabinet lines feature a glazed finish which accentuates the door and drawer front profiles. This glaze is hand applied over a stain or paint and may, due to the nature of application, consist of random drips, runs, etc. As glazing is a hand applied process there will be variations in color and appearance from door to door and cabinet to cabinet. This is not considered a defect and is considered normal with hand applied finishes. It is the nature of wood to expand and contract to varying degrees depending on climate conditions. As a result, cabinet lines with painted surfaces may show fractures in the paint at joints. This is normal and is not considered a defect.

This warranty is valid only in the United States of America and Canada and is not transferable. All implied warranties are limited in duration to the shorter of the period provided by law or the period of this warranty. To the extent permitted by law, this warranty excludes special, incidental, or consequential damages. Some states do not allow the exclusion or limitations of incidental or consequential damages or limitations on how long an implied warranty lasts, so the above limitations or exclusions may not apply to you. This warranty gives you specific legal rights; you may have other rights which vary from state to state. To exercise this warranty, please contact the US Cabinet Depot supplier from whom you purchased the product. Report, in writing, to support@uscabinetdepot.com all defects claimed and include proof of purchase documentation.

ALPINE

ALPINE DOOR SERIES STYLES & SPECIFICATIONS

(*Specifications subject to change without notice)

PALERMO

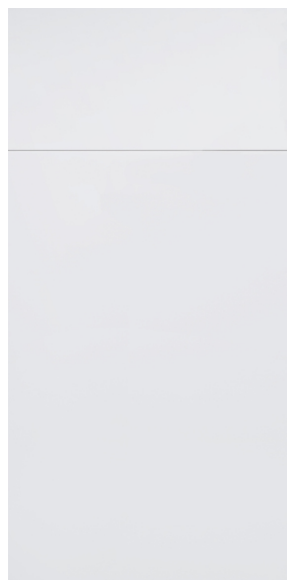

GLOSS WHITE (PGW)

- Frameless Construction
- Scratch Resistant High Gloss White "PET" Laminate with White Melamine Back
- Universal Box is a White/Grey Linen Thermofused Melamine Carcass with Matching Interior
- Pre-Assembled Blum "Legra" Drawer System
- Full Depth Nominal 3/4" Adjustable Shelf with Full Edge Banding
- Nominal 3/4" Plywood Core Box
- Hettich "Sensy" Adjustable 110 Degree Soft-Close Hinge
- Adjustable Black Leg Support Included

ALPINE DOOR SERIES STYLES & SPECIFICATIONS

(*Specifications subject to change without notice)

TORINO



**WHITE PINE
(TWP)**

- Frameless Construction
- Horizontal Textured Melamine White Woodgrain Engineered Wood Slab Door with Matching Back
- Universal Box is a White/Grey Linen Thermofused Melamine Carcass with Matching Interior
- Pre-Assembled Blum "Legra" Drawer System
- Full Depth Nominal 3/4" Adjustable Shelf with Full Edge Banding
- Nominal 3/4" Plywood Core Box
- Hettich "Sensy" Adjustable 110 Degree Soft-Close Hinge
- Adjustable Black Leg Support Included



**GREY WOOD
(TGW)**

- Frameless Construction
- Horizontal Textured Melamine Grey Woodgrain Engineered Wood Slab Door with Matching Back
- Universal Box is a White/Grey Linen Thermofused Melamine Carcass with Matching Interior
- Pre-Assembled Blum "Legra" Drawer System
- Full Depth Nominal 3/4" Adjustable Shelf with Full Edge Banding
- Nominal 3/4" Plywood Core Box
- Hettich "Sensy" Adjustable 110 Degree Soft-Close Hinge
- Adjustable Black Leg Support Included



**DARK WOOD
(TDW)**

- Frameless Construction
- Horizontal Textured Melamine Dark Brown Woodgrain Engineered Wood Slab Door with Matching Back
- Universal Box is a White/Grey Linen Thermofused Melamine Carcass with Matching Interior
- Pre-Assembled Blum "Legra" Drawer System
- Full Depth Nominal 3/4" Adjustable Shelf with Full Edge Banding
- Nominal 3/4" Plywood Core Box
- Hettich "Sensy" Adjustable 110 Degree Soft-Close Hinge
- Adjustable Black Leg Support Included

ALPINE

ALPINE DOOR SERIES STYLES & SPECIFICATIONS

(*Specifications subject to change without notice)

RIVERA



**OYSTER SHELL
(ROS)**

- Frameless Construction
- Vertical Textured Melamine Oyster Shell Engineered Wood Slab Door with Matching Back
- Universal Box is a White/Grey Linen Thermofused Melamine Carcass with Matching Interior
- Pre-Assembled Blum "Legra" Drawer System
- Full Depth Nominal 3/4" Adjustable Shelf with Full Edge Banding
- Nominal 3/4" Plywood Core Box
- Hettich "Sensy" Adjustable 110 Degree Soft-Close Hinge
- Adjustable Black Leg Support Included



**CONCH SHELL
(RCS)**

- Frameless Construction
- Vertical Textured Melamine Conch Shell Engineered Wood Slab Door with Matching Back
- Universal Box is a White/Grey Linen Thermofused Melamine Carcass with Matching Interior
- Pre-Assembled Blum "Legra" Drawer System
- Full Depth Nominal 3/4" Adjustable Shelf with Full Edge Banding
- Nominal 3/4" Plywood Core Box
- Hettich "Sensy" Adjustable 110 Degree Soft-Close Hinge
- Adjustable Black Leg Support Included

ALPINE DOOR SERIES STYLES & SPECIFICATIONS

(*Specifications subject to change without notice)

CONSTRUCTION SPECIFICATIONS

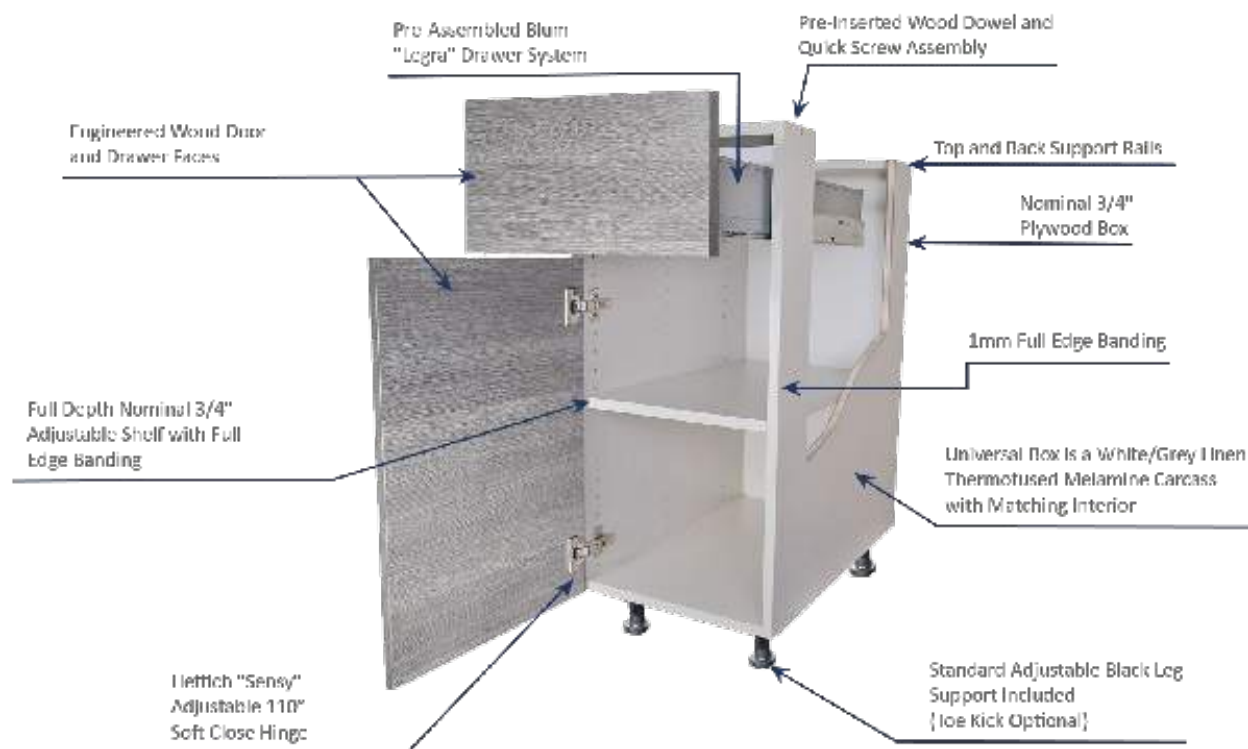

WALL CABINETS - PRODUCT SPECIFICATIONS

Two Door 13.5" Deep Stacker Wall Cabinets

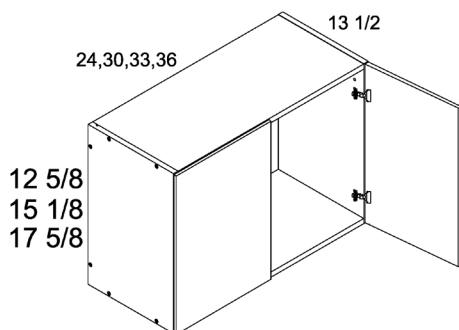

MODEL

W2412
W3012
W3312
W3612
W2415
W3015
W3615
W2418
W3018
W3318
W3618

One Door 13.5" Deep Stacker Wall Cabinets

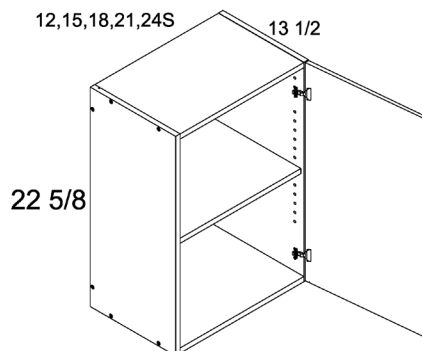

MODEL

W1223
W1523
W1823
W2123
W2423S

Two Door 13.5" Deep Stacker Wall Cabinets

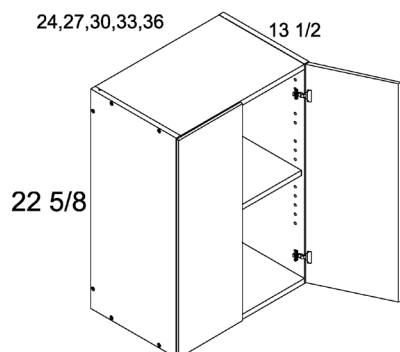

MODEL

W2423
W2723
W3023
W3323
W3623

One Door 24" Deep Stacker Wall Cabinets

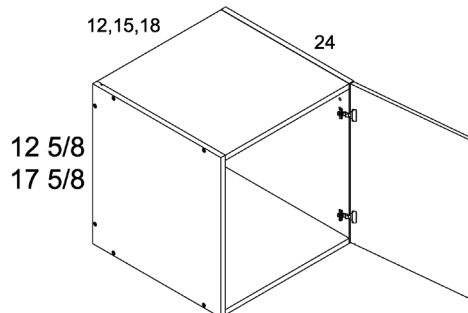

MODEL

W121224
W151224
W181224
W121824
W151824
W181824

ALPINE

WALL CABINETS - PRODUCT SPECIFICATIONS

Two Door 24" Deep Stacker Wall Cabinets

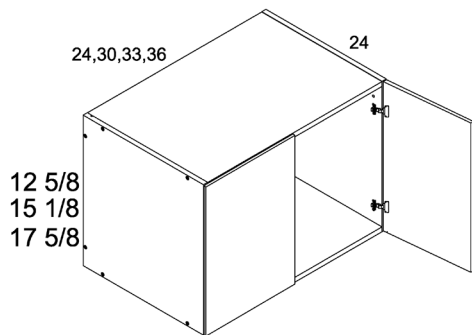

MODEL
W241224
W301224
W331224
W361224
W361524
W241824
W301824
W331824
W361824

One Door 24" Deep Stacker Wall Cabinets

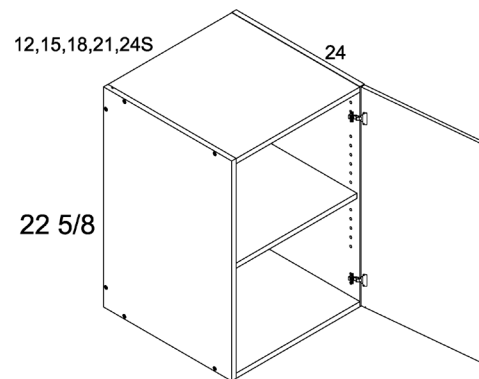

MODEL
W122324
W152324
W182324
W242324S

Two Door 24" Deep Stacker Wall Cabinets

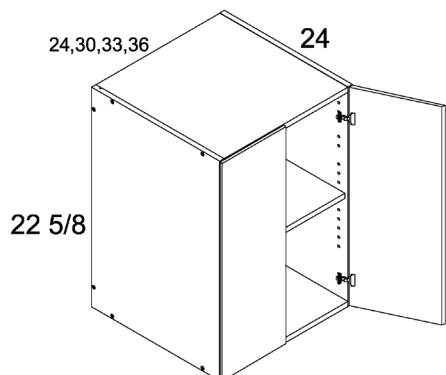

MODEL
W242324
W302324
W332324
W362324

One Door 30" High Wall Cabinets

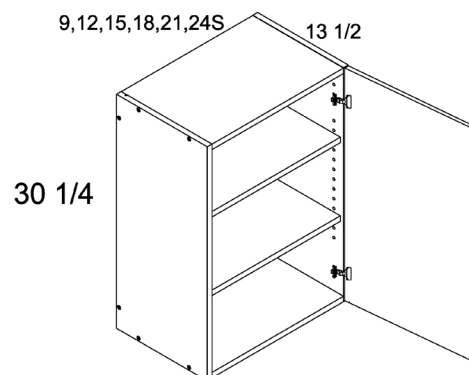

MODEL
W0930
W1230
W1530
W1830
W2130
W2430S

WALL CABINETS - PRODUCT SPECIFICATIONS

Two Door 30" High Wall Cabinets

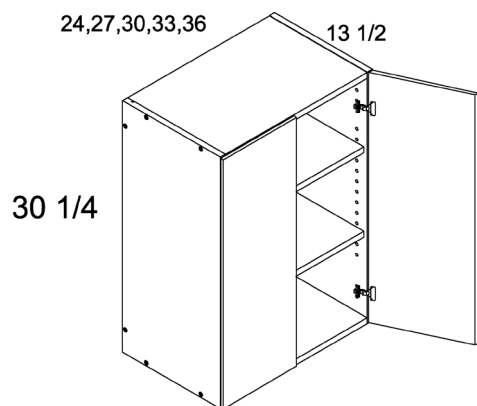

MODEL
W2430
W2730
W3030
W3330
W3630

One Door 35" High Wall Cabinets

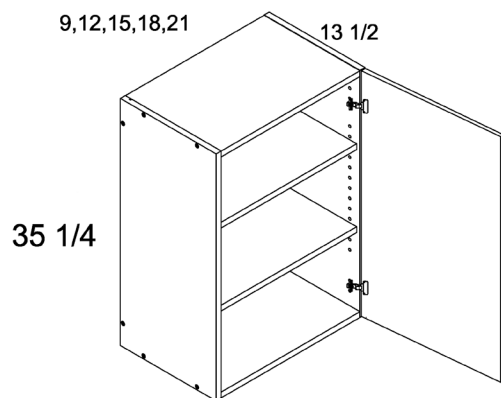

MODEL
W0935
W1235
W1535
W1835
W2135

Two Door 35" High Wall Cabinets

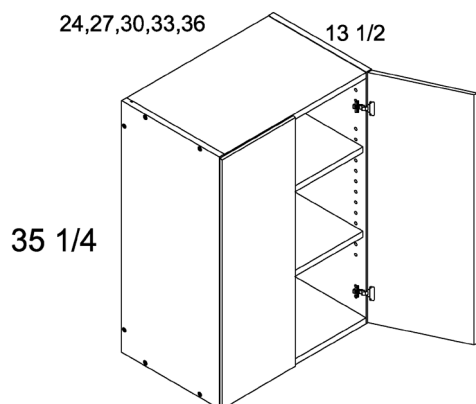

MODEL
W2435
W2735
W3035
W3335
W3635

One Door 40" High Wall Cabinets

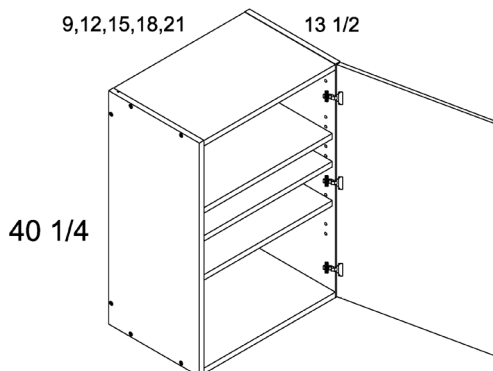

MODEL
W0940
W1240
W1540
W1840
W2140

ALPINE

WALL CABINETS - PRODUCT SPECIFICATIONS

Two Door 40" High Wall Cabinets

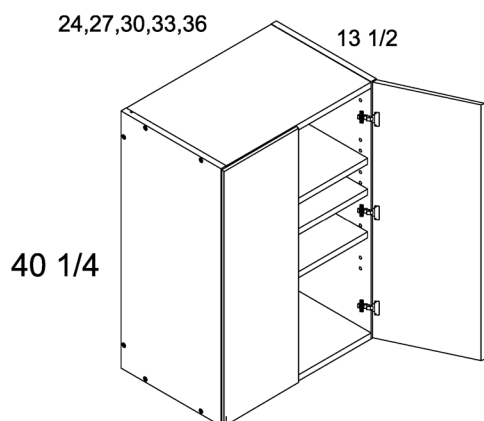

MODEL
W2440
W2740
W3040
W3340
W3640

13.5" Deep Flip Up Door Wall Cabinets

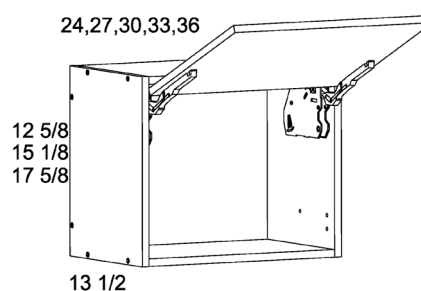

MODEL
WFD2421
WFD2712
WFD3012
WFD3312
WFD3612
WFD2415
WFD2715
WFD3015
WFD3315
WFD3615
WFD2418
WFD2718
WFD3018
WFD3318
WFD3618

24" Deep Flip Up Door Wall Cabinets

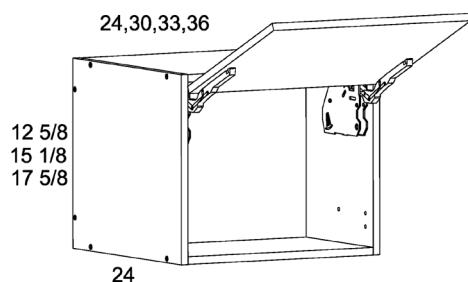

MODEL
WFD241224
WFD241824
WFD301224
WFD301824
WFD331224
WFD331824
WFD361224
WFD361524
WFD361824

Wall Blind Corner Cabinets

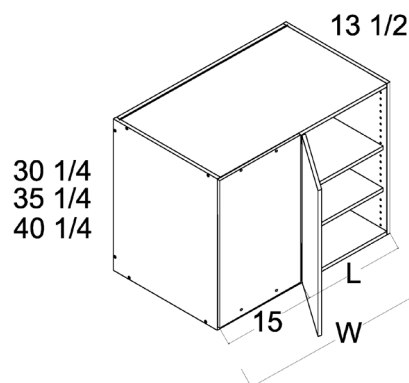

MODEL
WBC24/2730
WBC27/3030
WBC30/3330
WBC33/3630
WBC36/3930
WBC24/2735
WBC27/3035
WBC30/3335
WBC33/3635
WBC24/2740
WBC27/3040
WBC30/3340
WBC33/3640

CABINET PULL CHART		
CABINET	MIN.	MAX.
WBC24/27	24	27
WBC27/30	27	30
WBC30/33	30	33
WBC33/36	33	36
WBC36/39	36	39

CODE	W	L
WBC24/27	24	9
WBC27/30	27	12
WBC30/33	30	15
WBC33/36	33	18
WBC36/39	36	21

WALL CABINETS - PRODUCT SPECIFICATIONS

Wall Easy Reach Corner Cabinets

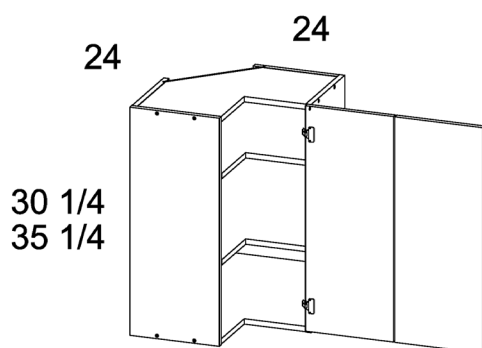

MODEL
WER2430
WER2435

Wall Easy Reach Corner Cabinets

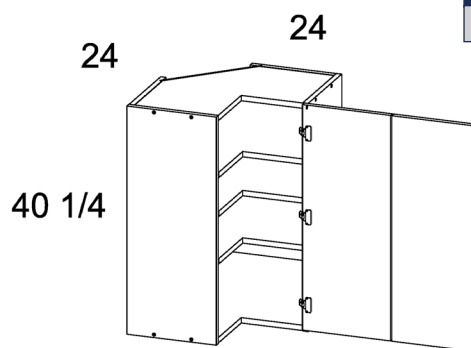

MODEL
WER2440

ALPINE

BASE CABINETS - PRODUCT SPECIFICATIONS

Base Rollout with Basket Pullout

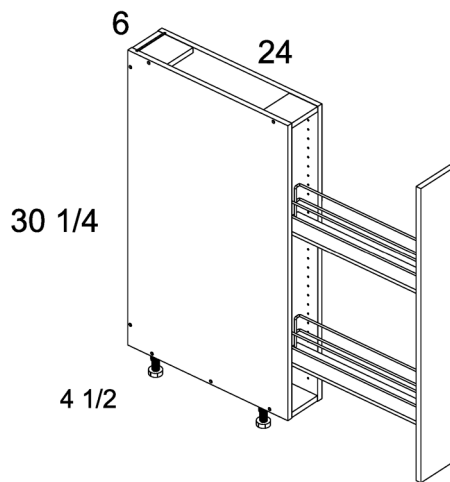

MODEL
BPO6FH

Base Rollout with Tray Pullout

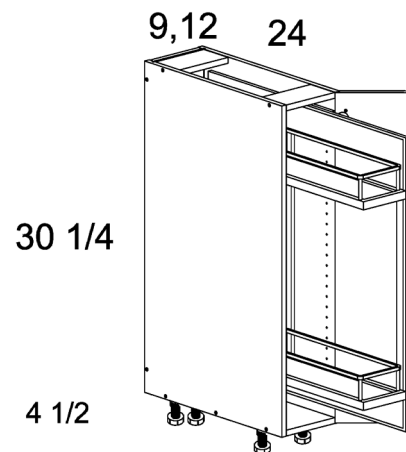

MODEL
BPO9FH
BPO12FH

Full Height One Door Bases

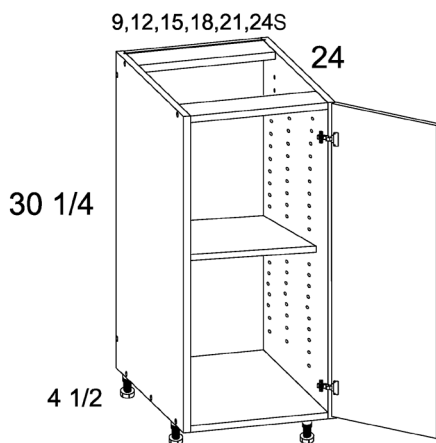

MODEL
BT9FH
B12FH
B15FH
B18FH
B21FH
B24SFH

Full Height Two Door Bases

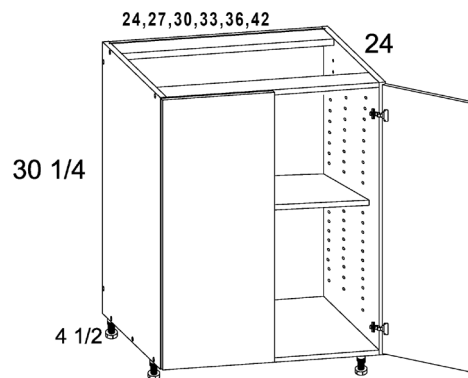

MODEL
B24FH
B27FH
B30FH
B33FH
B36FH
B42FH

BASE CABINETS - PRODUCT SPECIFICATIONS

One Door One Drawer Bases

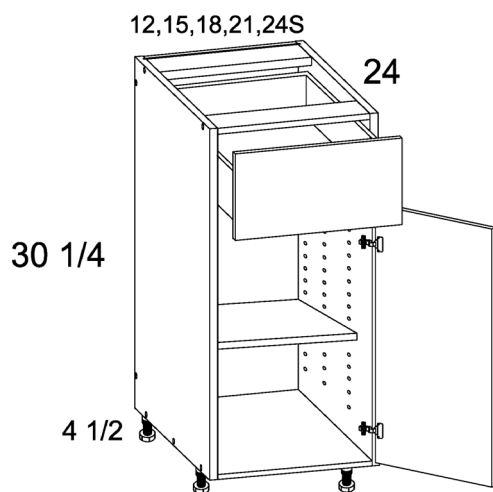

MODEL
B12
B15
B18
B21
B24S

Two Door One Drawer Bases

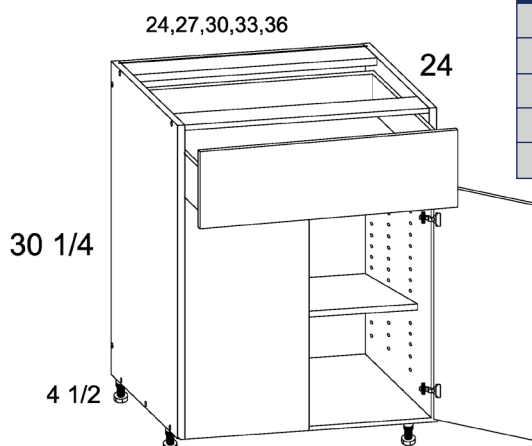

MODEL
B24
B27
B30
B33
B36

Two Drawer Bases

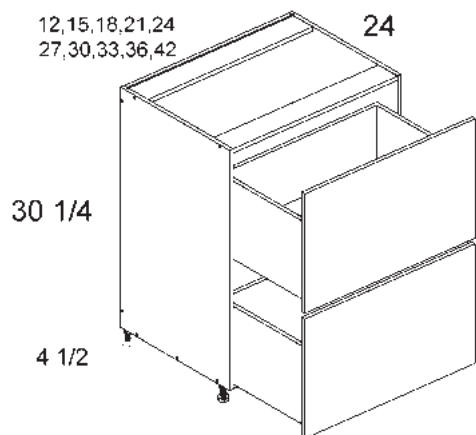

MODEL
2DB12
2DB15
2DB18
2DB21
2DB24
2DB27
2DB30
2DB33
2DB36
2DB42

Two Drawer Bases with Inner Drawer

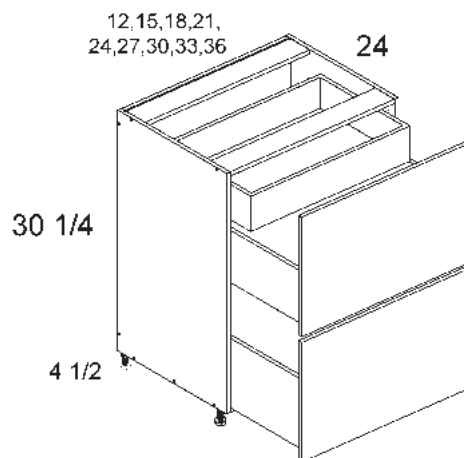

MODEL
2DBID12
2DBID15
2DBID18
2DBID21
2DBID24
2DBID27
2DBID30
2DBID33
2DBID36

ALPINE

BASE CABINETS - PRODUCT SPECIFICATIONS

Three Drawer Bases

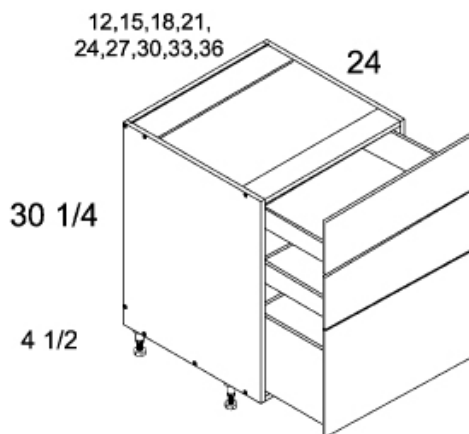

MODEL
3DB12
3DB15
3DB18
3DB21
3DB24
3DB27
3DB30
3DB33
3DB36

Four Drawer Bases

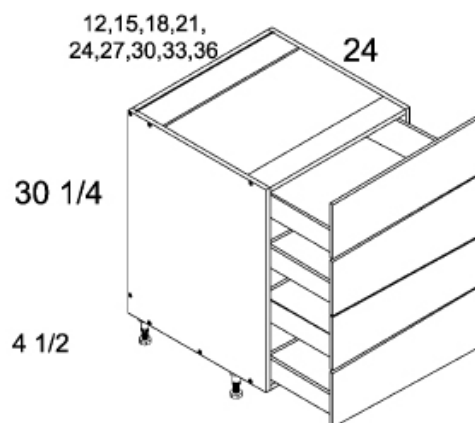

MODEL
4DB12
4DB15
4DB18
4DB21
4DB24
4DB27
4DB30
4DB33
4DB36

Full Height One Door Sink Bases

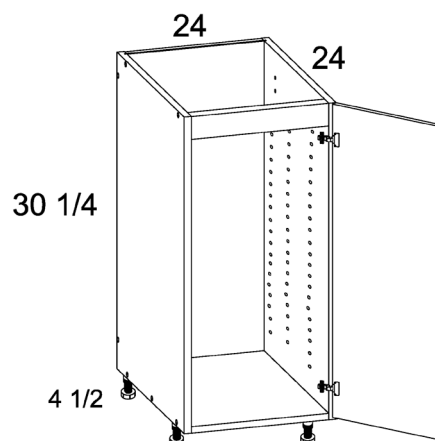

MODEL
SB24SFH

Full Height Two Door Sink Bases

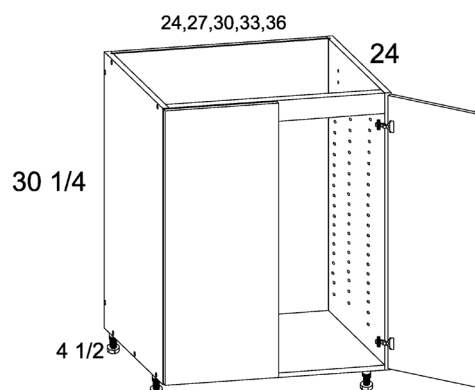

MODEL
SB24FH
SB27FH
SB30FH
SB33FH
SB36FH

BASE CABINETS - PRODUCT SPECIFICATIONS

One Door with False Front Drawer Sink Bases

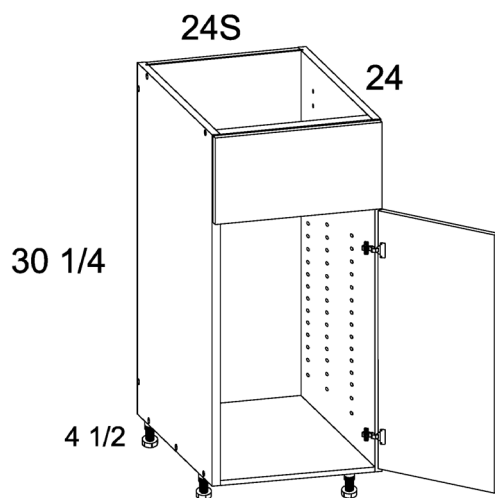

MODEL
SB24S

Two Door with False Front Drawer Sink Bases

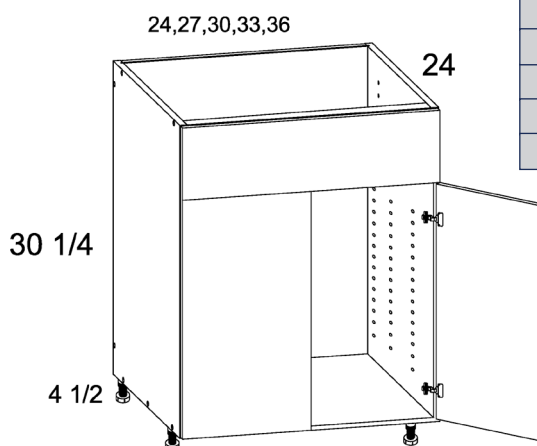

MODEL
SB24
SB27
SB30
SB33
SB36

Two Drawer Range Bases

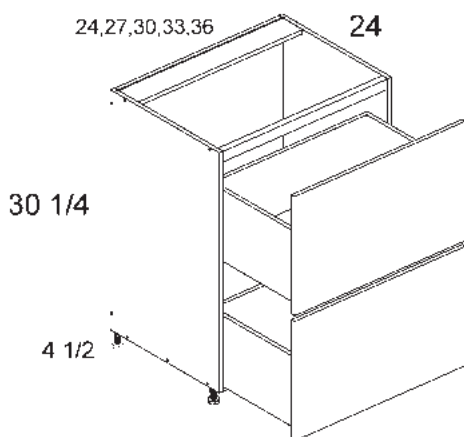

MODEL
RB2DB24
RB2DB27
RB2DB30
RB2DB33
RB2DB36

Two Drawer with False Front Range Bases

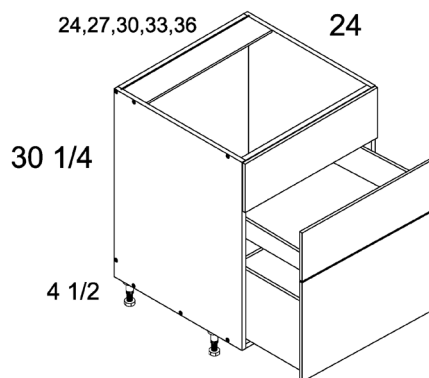

MODEL
RB3DB24
RB3DB27
RB3DB30
RB3DB33
RB3DB36

ALPINE

BASE CABINETS - PRODUCT SPECIFICATIONS

Three Drawer with False Front Range Bases

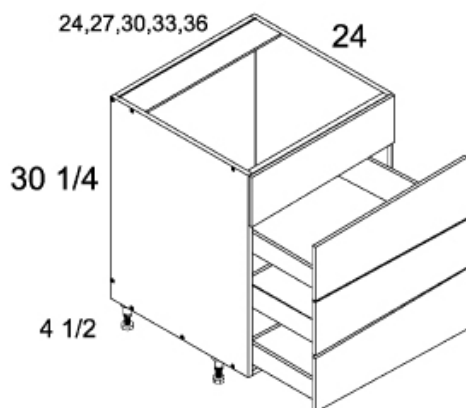

MODEL
RB4DB24
RB4DB27
RB4DB30
RB4DB33
RB4DB36

Full Height One Door Blind Bases

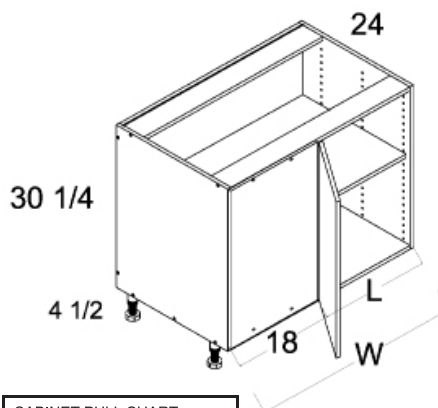

MODEL
BBC37/40FH
BBC40/43FH
BBC43/46FH
BBC46/49FH
BBC49/52SFH

CABINET PULL CHART		
CABINET	MIN.	MAX.
BBC37/40FH	37	40
BBC40/43FH	40	43
BBC43/46FH	43	46
BBC46/49FH	46	49
BBC49/52SFH	49	52

CODE	W	L
BBC37/40 FH	30	12
BBC40/43 FH	33	15
BBC43/46 FH	36	18
BBC46/49 FH	36	21
BBC49/52 FH	42	24

Full Height Two Door Blind Bases

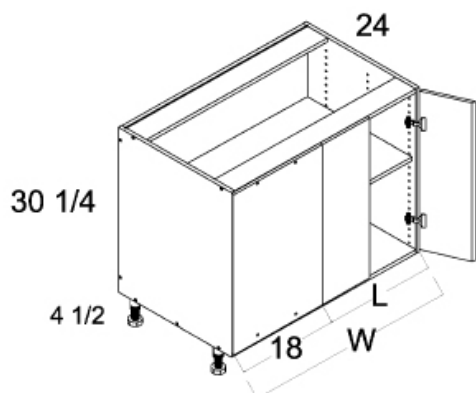

MODEL
BBC49/52FH
BBC52/55FH

CABINET PULL CHART		
CABINET	MIN.	MAX.
BBC49/52FH	49	52
BBC52/55FH	52	55

CODE	W	L
BBC49/52 FH	42	24
BBC52/55 FH	45	27

Base Easy Reach

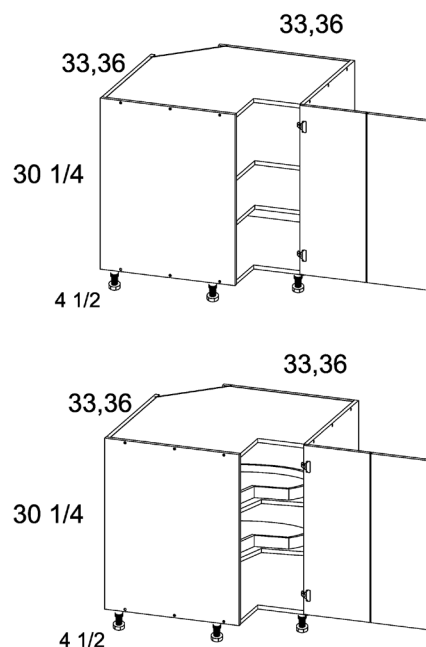

MODEL
BER33
BER36

MODEL
LSB33
LSB36

BASE CABINETS - PRODUCT SPECIFICATIONS

Microwave Base

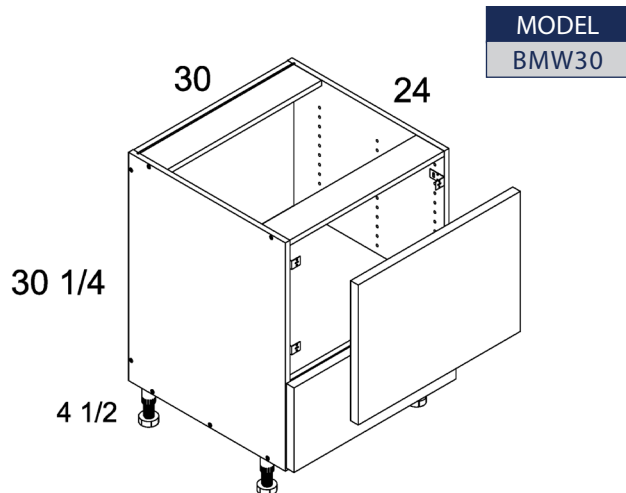

Full Height One Door Desk Bases

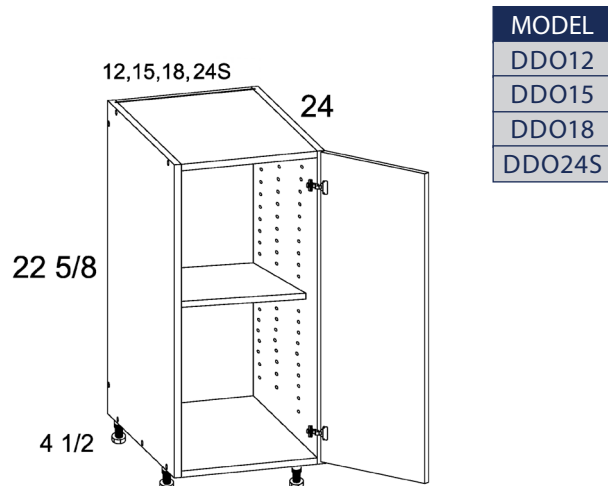

Full Height Two Drawer Desk Bases

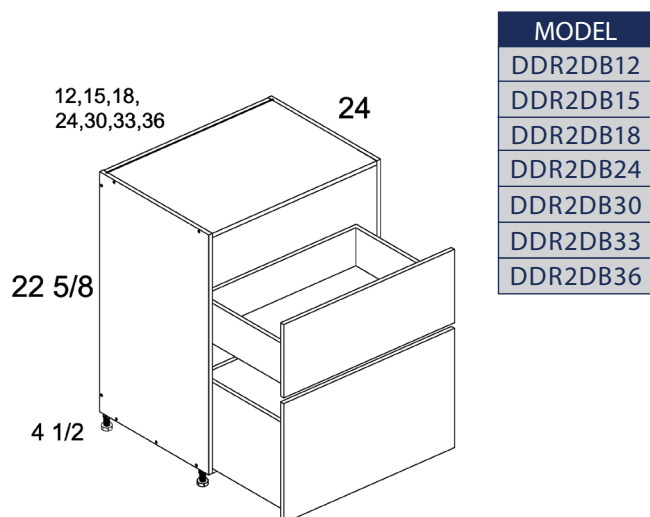

Full Height Three Drawer Desk Bases

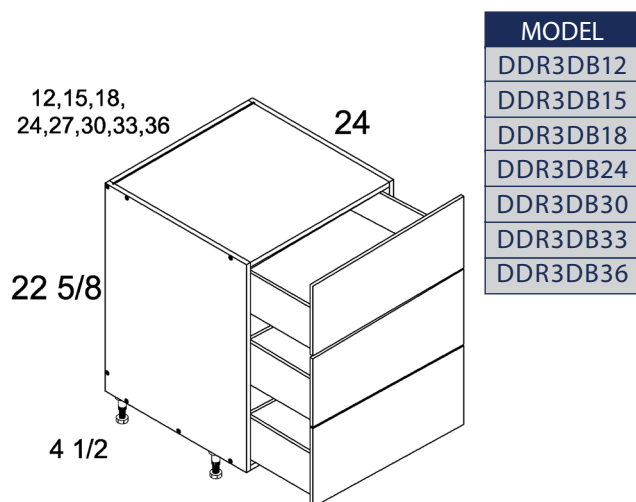

ALPINE

TALL CABINETS - PRODUCT SPECIFICATIONS

Tall Open Utility with Two Doors

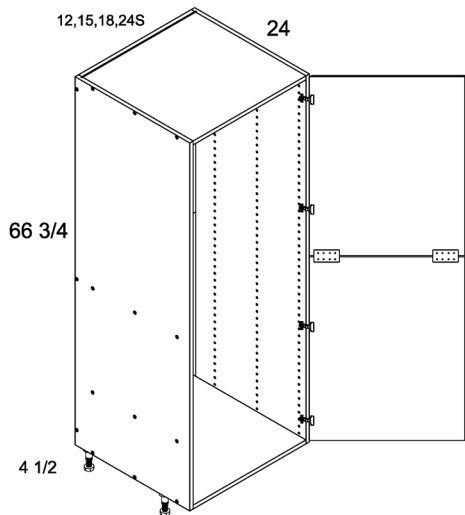

MODEL

T1272
T1572
T1872
T2472S

Tall Open Utility with Four Doors

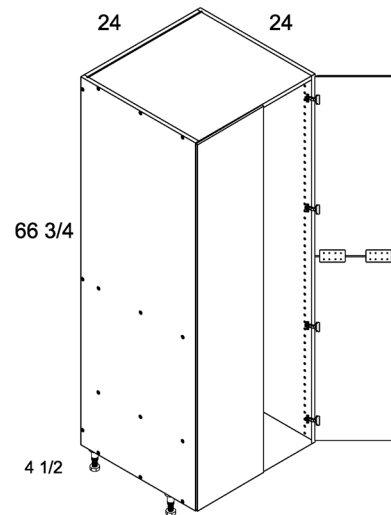

MODEL

T2472

Tall Full Height Two Door Utility

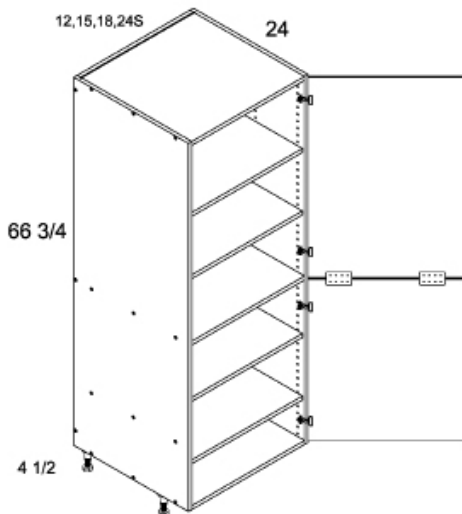

MODEL

TB1272FH
TB1572FH
TB1872FH
TB2472SFH

Tall Full Height Four Door Utility

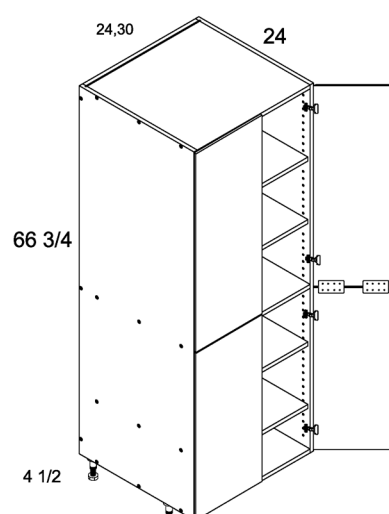

MODEL

TB2472FH
TB3072FH

TALL CABINETS - PRODUCT SPECIFICATIONS

Tall Two Door One Drawer Utility

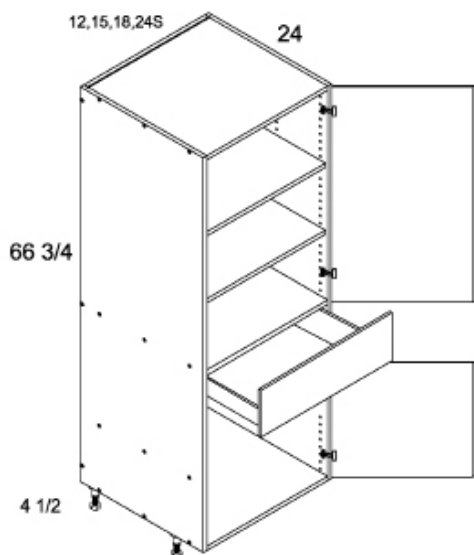

MODEL

TB1272

TB1572

TB1872

TB2472S

Tall Four Door One Drawer Utility

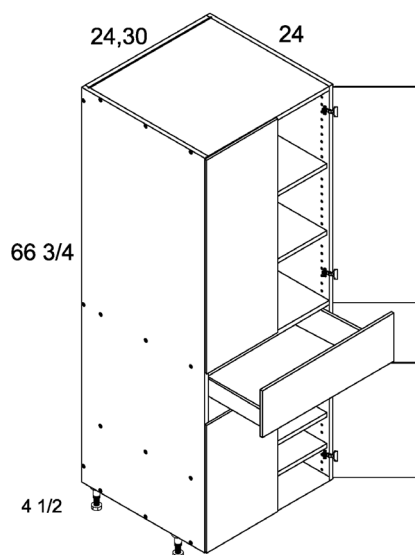

MODEL

TB2472

TB3072

Tall One Door Two Drawer Utility

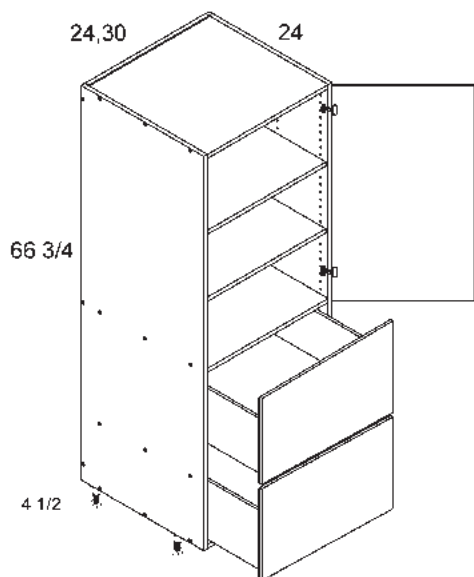

MODEL

T2DB1272

T2DB1572

T2DB1872

T2DB2472S

Tall Two Door Two Drawer Utility

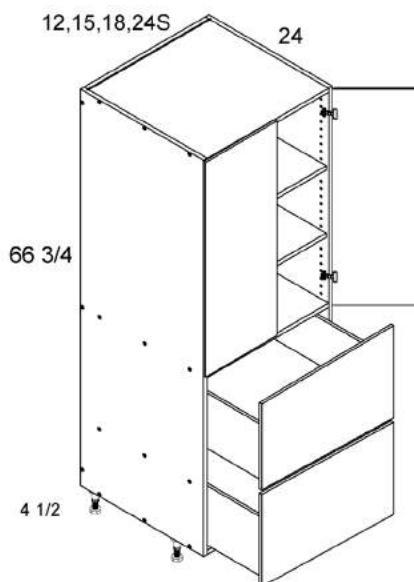

MODEL

T2DB2472

T2DB3072

ALPINE

TALL CABINETS - PRODUCT SPECIFICATIONS

Tall One Door Two Drawer with One Inner Drawer Utility

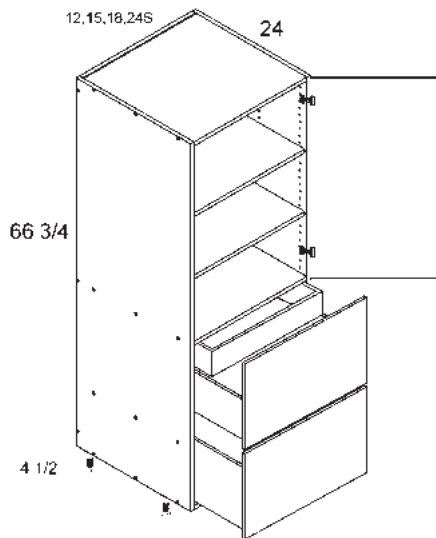

MODEL
T2DBID1272
T2DBID1572
T2DBID1872
T2DBID2472S

Tall Two Door Two Drawer with One Inner Drawer Utility

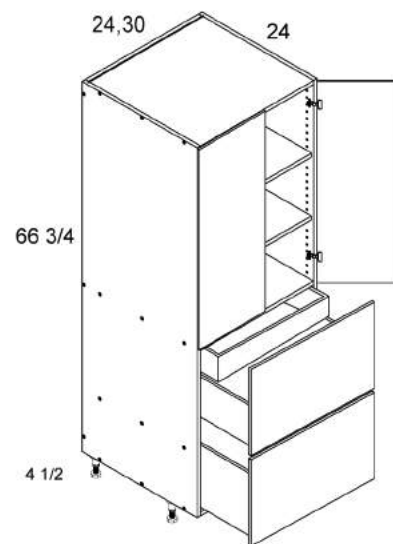

MODEL
T2DBID2472
T2DBID3072

Tall One Door Three Drawer Utility

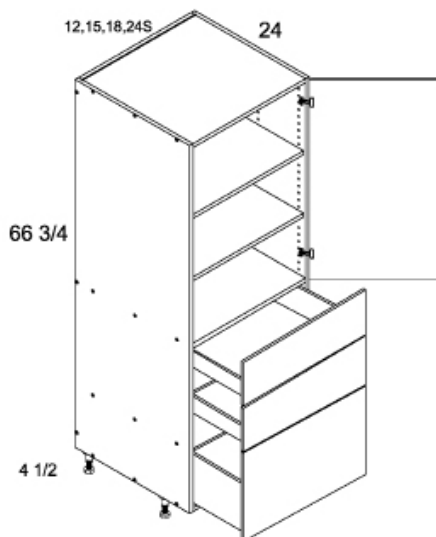

MODEL
T3DB1272
T3DB1572
T3DB1872
T3DB2472S

Tall Two Door Three Drawer Utility

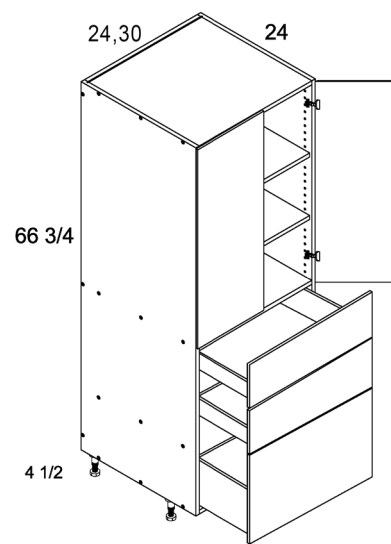

MODEL
T3DB2472
T3DB3072

TALL CABINETS - PRODUCT SPECIFICATIONS

Tall One Door Four Drawer Utility

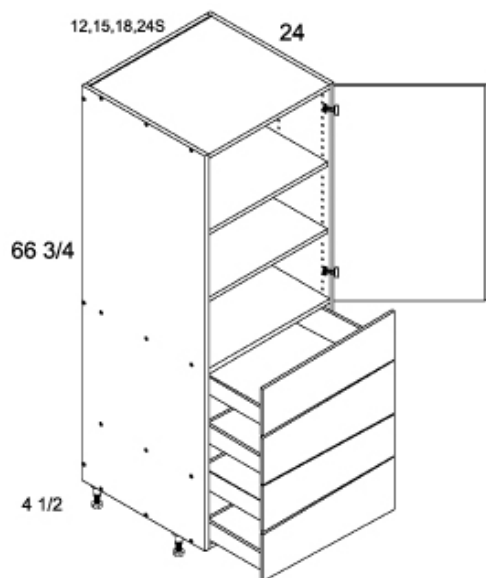

MODEL
T4DB1272
T4DB1572
T4DB1872
T4DB2472S

Tall Two Door Four Drawer Utility

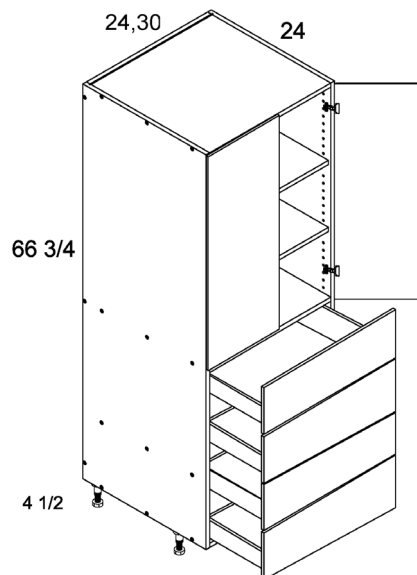

MODEL
T4DB2472
T4DB3072

Tall Single Oven Full Height Two Door Utility

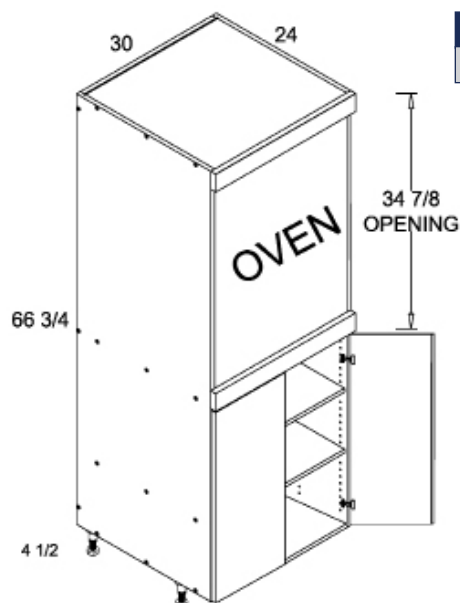

MODEL
TOS3072FH

Tall Single Oven Two Door One Drawer Utility

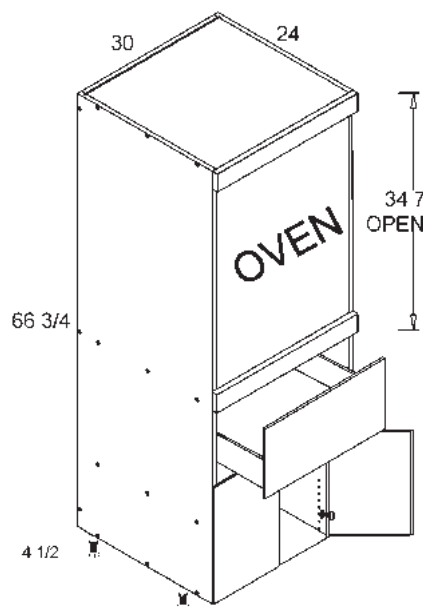

MODEL
TOSB3072

ALPINE

TALL CABINETS - PRODUCT SPECIFICATIONS

Tall Single Oven Two Drawer Utility

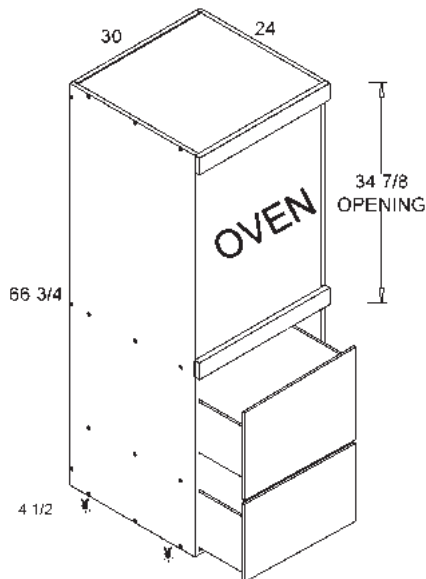

Tall Single Oven Two Drawer with One Inner Drawer Utility

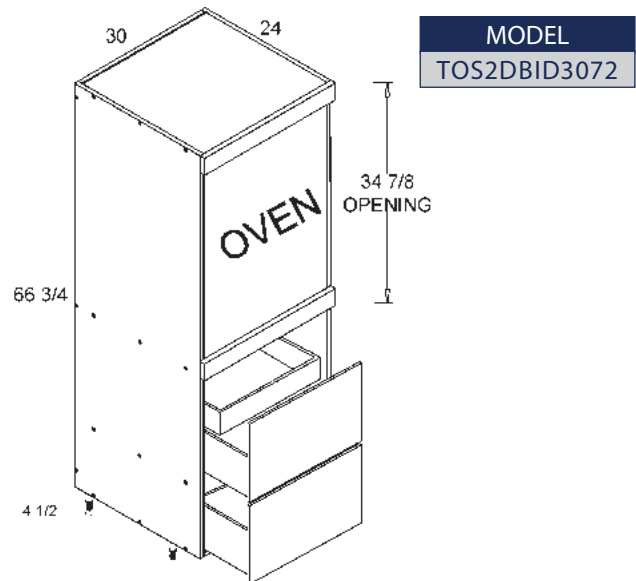

Tall Single Oven Three Drawer Utility

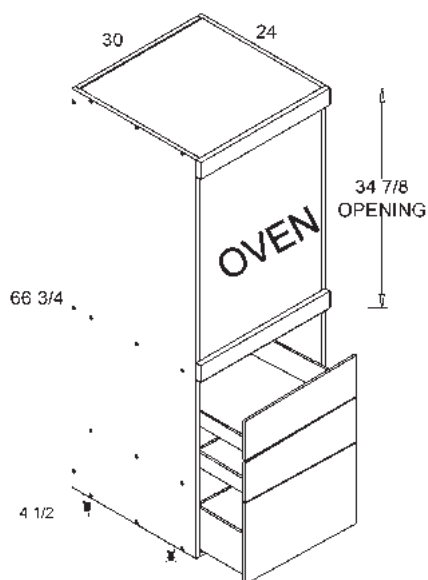

Tall Single Oven Four Drawer Utility

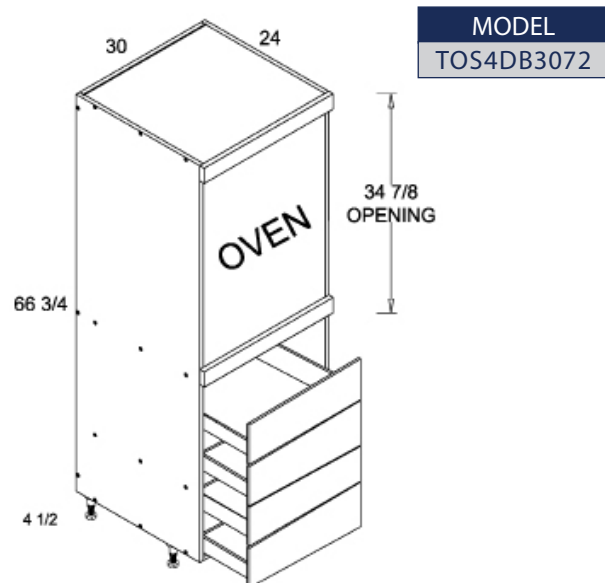

TALL CABINETS - PRODUCT SPECIFICATIONS

Tall Double Oven One Drawer Utility

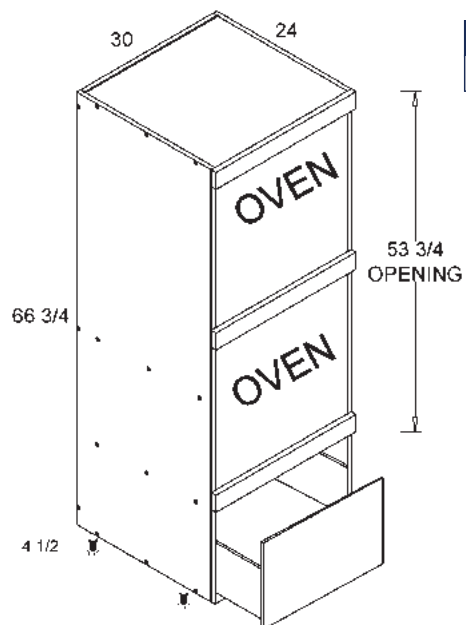

MODEL
TOD3072

ALPINE

VANITIES - PRODUCT SPECIFICATIONS

Full Height One Door Vanity Bases

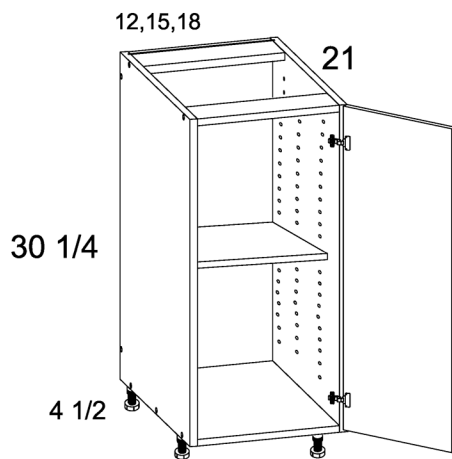

MODEL

VB12FH

VB15FH

VB18FH

One Door One Drawer Vanity Bases

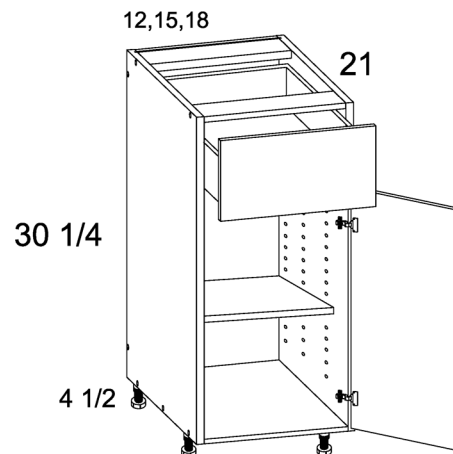

MODEL

VB12

VB15

VB18

Two Drawer Vanity Bases

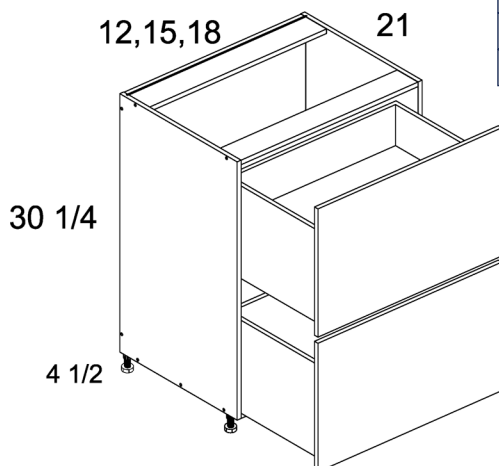

MODEL

2VDB12

2VDB15

2VDB18

Two Drawer with One Inner Drawer Vanity Bases

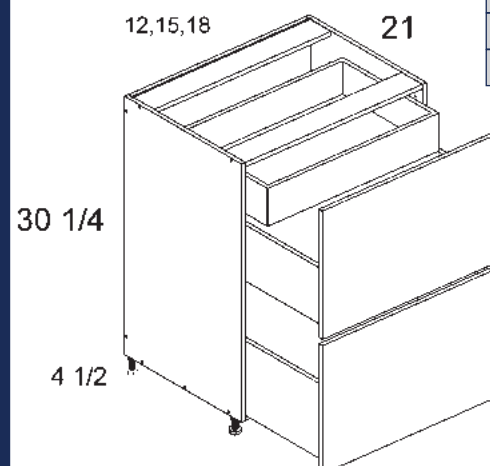

MODEL

2VDBID12

2VDBID15

2VDBID18

VANITIES - PRODUCT SPECIFICATIONS

Three Drawer Vanity Bases

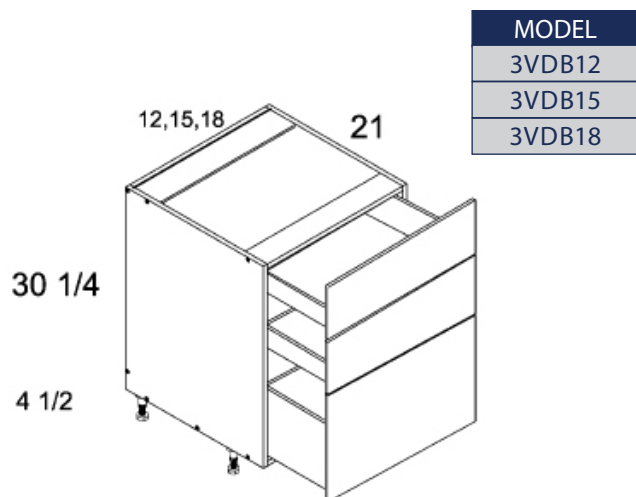

Four Drawer Vanity Bases

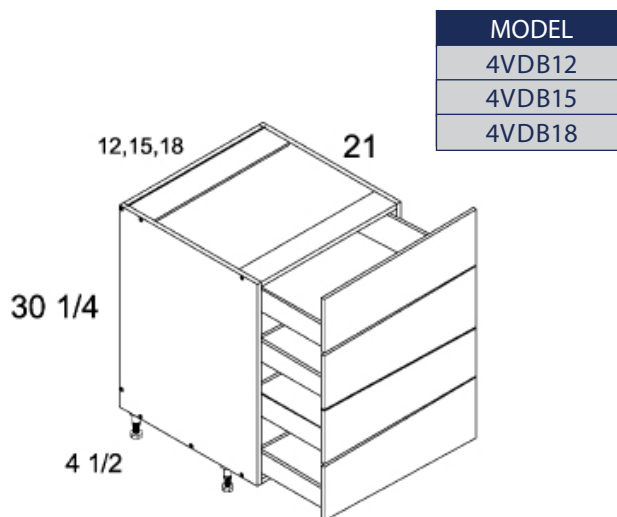

Full Height One Door Vanity Sink Bases

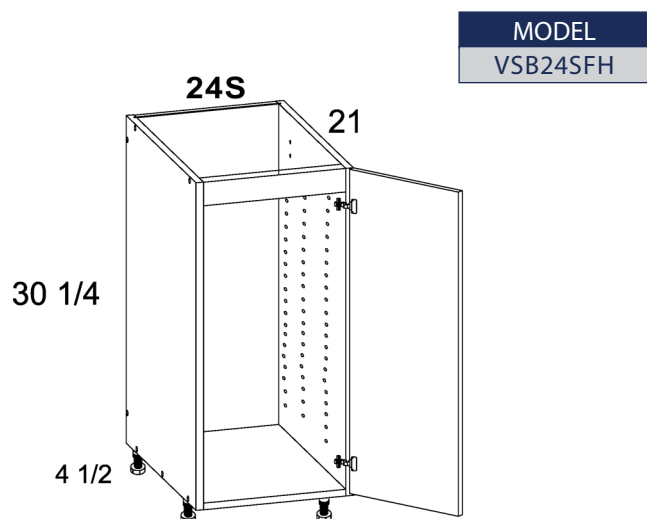

Full Height Double Door Vanity Sink Bases

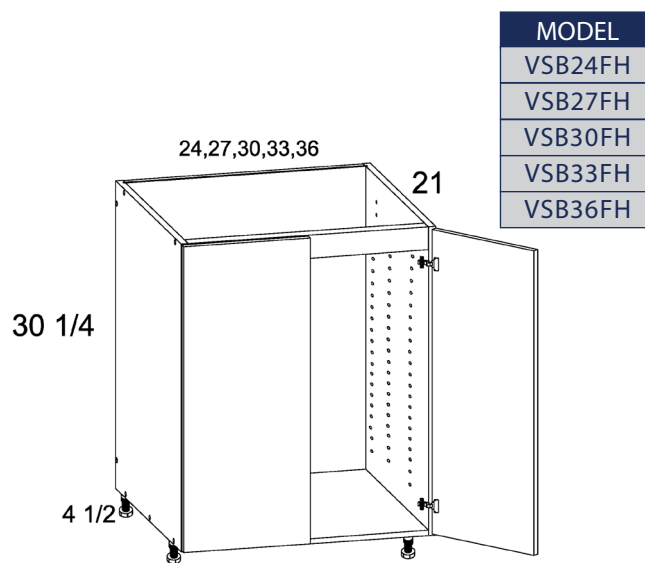

ALPINE

VANITIES - PRODUCT SPECIFICATIONS

Vanity Sink Base False Front One Door

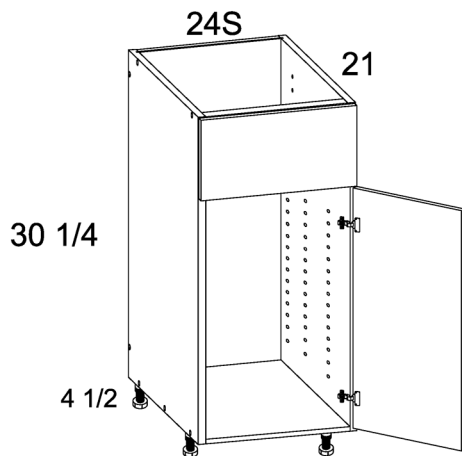

MODEL
VSB24S

Vanity Sink Base False Front Two Door

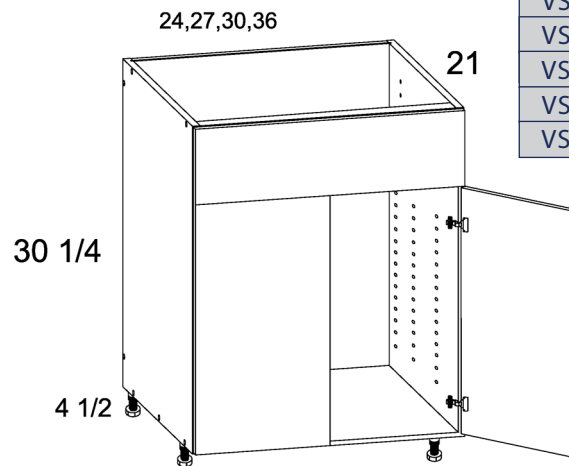

MODEL
VSB24
VSB27
VSB30
VSB33
VSB36

PANELS, FILLERS & MOULDINGS - PRODUCT SPECIFICATIONS

Moulding - TKC-PVC

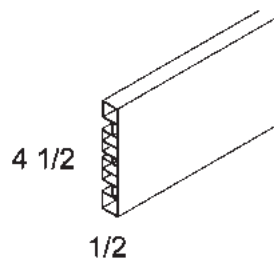

*BRUSHED ALUMINUM FINISH

MODEL
TKC-PVC8
TKC-PVC3

Moulding - Corner-PVC

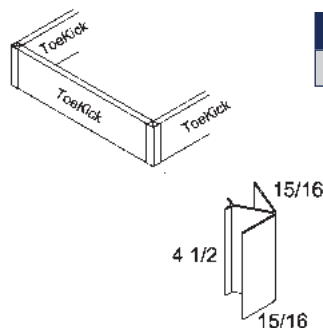

MODEL
Corner-PVC

Moulding - SM8

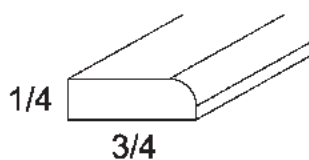

MODEL
SM8

Moulding - BM8

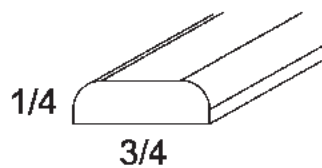

MODEL
BM8

Moulding - OCM8

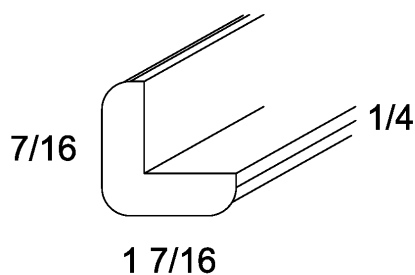

MODEL
OCM8

Moulding - TKC

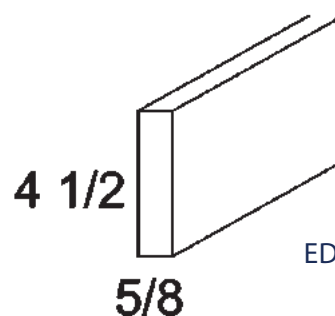

MODEL
TKC

EDGEBANDED ALL
FOUR EDGES

*Matching Laminate Face

ALPINE

PANELS, FILLERS & MOULDINGS - PRODUCT SPECIFICATIONS

Fillers - AF3006

MODEL
AF3006

Three pieces per item

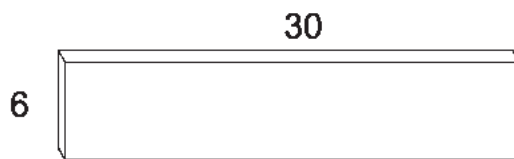

EDGEBANDED ALL
FOUR EDGES

*Oven Cabinet Horizontal Fillers

Fillers - OF3

MODEL
OF330
OF335
OF340
OF384
OF394

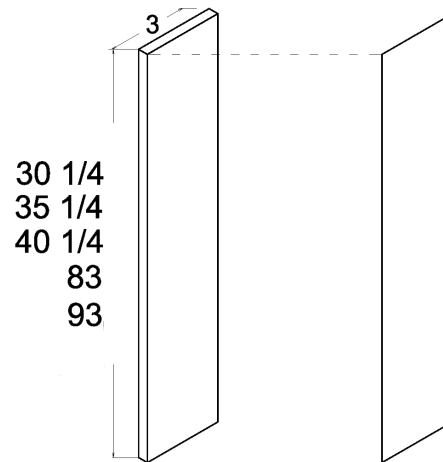

Fillers - OF6

MODEL
OF630
OF635
OF640
OF684
OF694

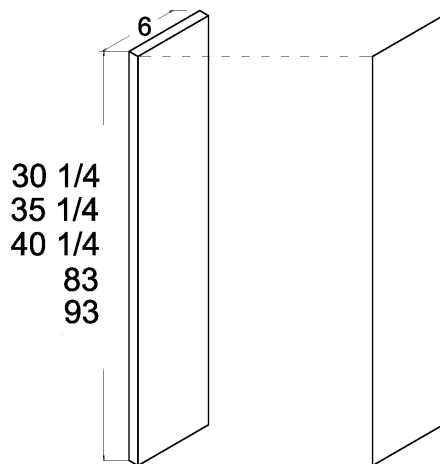

PANELS, FILLERS & MOULDINGS - PRODUCT SPECIFICATIONS

Panels - BEP2535

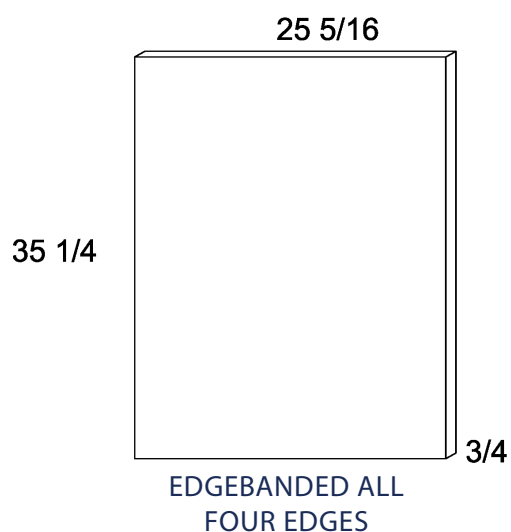

MODEL
BEP2535

Panels - WEP

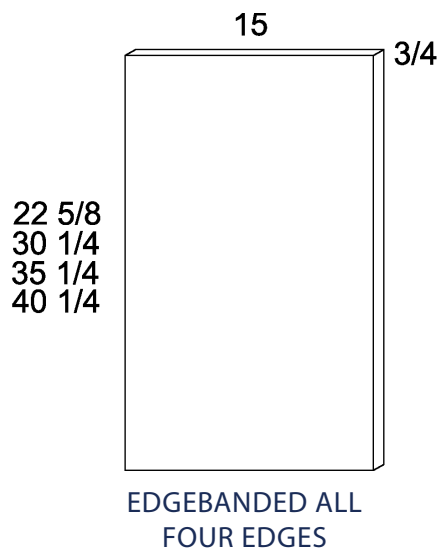

MODEL
WEP1523
WEP1530
WEP1535
WEP1540

Panels - BP9635

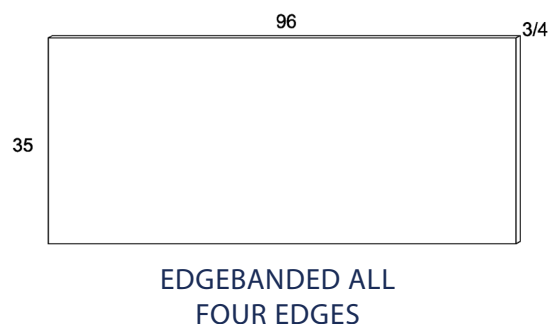

MODEL
BP9635

Panels - TEP3094

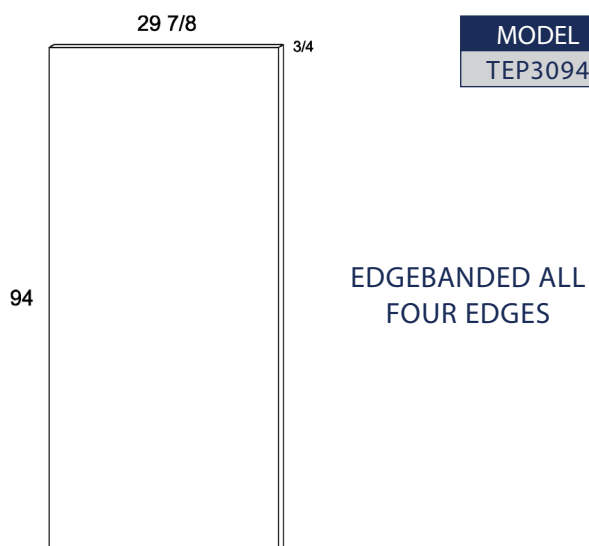

MODEL
TEP3094

*TEP3094 panels are a running change from the TEP2594 panels and may only be available in select finishes.

ALPINE

ACCESSORIES - PRODUCT SPECIFICATIONS

Floating Shelves

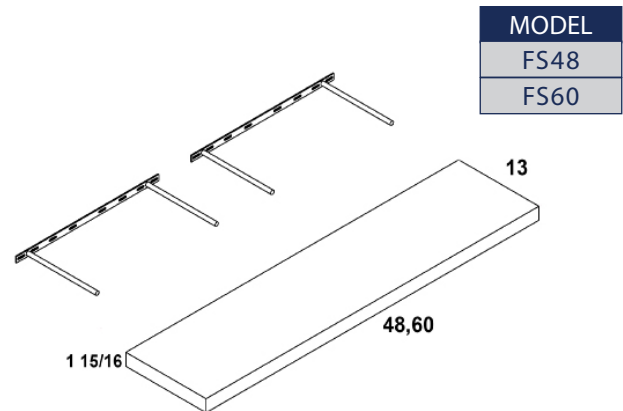
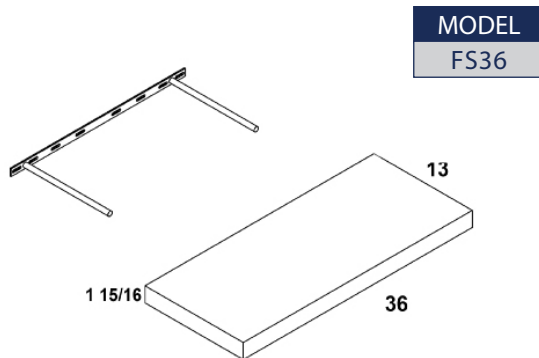



MAKING YOUR BUSINESS BETTER WITH US

WWW.USCABINETDEPOT.COM

Email: info@uscabinetdepot.com

Toll Free: 844-660-9889
(M-F 8:30am - 4:30pm EST)

Fax: 770-767-3806